

GENERAL SAFETY RULES

WARNING: Read and understand all instructions. Failure to follow all instructions listed below may result in electric shock, fire and/or serious personal injury.

SAVE THESE INSTRUCTIONS

- **Avoid dangerous environments.** Don't use appliances in damp or wet locations. Don't use appliances in the rain.
- **Keep away from children.**
- **Store the inverter carefully when not in use.** When not in use, appliances should be stored indoors in a high and dry locked area,out of reach of children.
- **Use the inverter for its intended purpose ONLY.** Do not overload the inverter. Trying to power an appliance that draws a wattage larger than the inverter's capability will result in damage to the inverter.
- **Use right appliance.**Do not use the appliance for any job except for which it is intended.
- **Disconnect appliances.** Disconnect the appliance from inverter when not in use.
- **Proper cooling is essential when operating the inverter.** Do not place the unit near the vehicle's heat vent or in direct sunlight.
- **Use of accessories and attachments.** Do not use any accessories or attachments that are not recommended to use with your appliance. The result could be hazardous and damage the unit.

SAFETY GUIDELINES: DEFINITIONS

DANGER: Indicates a hazardous situation, if not avoided, will result in death or serious injury.

WARNING: Indicates a potentially hazardous situation, if not avoided, could result in death or serious injury.

CAUTION: Indicates a potentially hazardous situation; if you don't follow the safety information and operating guidelines,could result in injury or property damage.

WARNING: Keep away from WATER, FIRE and SMOKE!

CAUTION: The inverter has protection functions such as over input voltage shut off, low input voltage shut off, over heating self-lock, overload self-lock and short circuit protection.

IMPORTANT SAFETY INFORMATION

WARNING: To reduce the risk of electric shock:

- Do not connect to AC distribution wiring.
- Do not make any electrical connections or disconnections in areas designated as ignition protected. This includes 12V/DC cigarette lighter type plug connection. This unit is NOT approved for ignition protected areas.
- Never immerse the unit in water or any other liquid, or use when wet.
- Do not insert foreign objects into the 110V/AC outlet or the USB outlet.

WARNING: To reduce the risk of fire.

- Do not operate near flammable materials, fumes or gases.
- Do not expose to extreme heat or flames.

CAUTION: To reduce the risk of injury or property damage:

- Do not attempt to connect or set up the unit or its components while operating your vehicle. Not paying attention to the road may result in a serious accident.
- Always use the inverter where there is adequate ventilation. Do not block ventilation areas.
- Always turn the inverter off before disconnecting the inverter from the vehicle battery.
- Make sure the nominal input voltage is 12V DC.
- Do not use with positive ground electrical systems*.
- * The majority of modern automobiles, RVs and trucks are negative ground.
- Keep in mind that this inverter is unable to power the appliances or equipment that produce heat, such as hair dryers, microwave ovens and toasters.
- **Do not open the inverter:** there are no user-serviceable parts inside.
- Do not use this inverter with medical devices. It is not tested for medical applications.
- Keep away from children. **This is not a toy!**
- Install and operate unit only as described in this instruction manual.

- Please be careful when you use this inverter in a boat. It is not qualified for marine applications.
- Check unit periodically for wear and tear. Take to a qualified technician for replacement of worn or defective parts immediately.
- Do not connect the unit to any utility power distribution, systems or branch circuits.
- Do not use the inverter in temperatures over 104°F or under 32°F.
- **Failure to follow these safety guidelines will result in personal injury and/or the damage to the unit. It may also void of the warranty.**
- Follow the instruction from the manufacturer of your vehicle battery and 110V/AC appliance before connecting the inverter to a battery. Please pay attention to the cautionary marking on your vehicle battery.

PRODUCT INTRODUCTION

Thank you for purchasing the MobileSpec™ inverter. Your inverter can be used to operate personal electronics such as shown below:

Watt	Appliance	MSI300
50-80W	Tablet	✓
60-100W	Laptop	✓
200W	Stereo	✓
250W	Computer	✓
60-300W	Game console	✓

Some digital appliances are not compatible with modified sine wave inverters. Check with appliance manufacturer for compatibility.

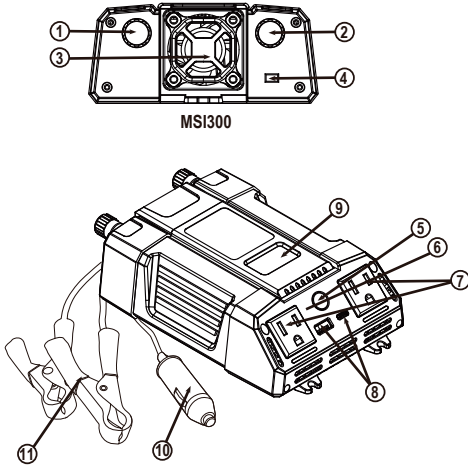

Only use one set of cables at a time.

FEATURES (Fig. A and B)

1. **Positive DC terminal:** Connect the red end of the DC power cord to it.
2. **Negative DC terminal:** Connect the black end of the DC power cord to it.
3. **Cooling Fan and Ventilation Openings:** The high speed cooling fan protects the inverter from over-heating.
4. **Reverse polarity connection indicator**
5. **ON/OFF push button**
6. **LED fault indicator**
7. **AC sockets**
8. **USB and USB-C™ ports**
9. **LCD screen to indicate working status**
10. **12-Volt plug with cable**
11. **Battery clip cable**

Powering inverter with 12V DC plug with cable will limit inverter output to approximately 150 watts. Most power ports are fused at 10 amps accordingly to the wire gauge behind the power port.

OPERATING TIPS

The inverter should only be operated in locations that are:

- a. Dry:** Do not allow water or other liquids to come into contact with the inverter.
- b. Cool:** Surrounding air temperature should ideally be 32°F and 104°F . Keep the inverter away from direct sunlight when possible.
- c. Well-Ventilated:** Keep the area surrounding the inverter clear to ensure free air circulation around the unit. Do not place items on or over the inverter during operation.

The unit will shut down if the internal temperature gets too hot.The inverter will auto-reset after it cools down.

d. Safe: Do not use the inverter near flammable materials or in any locations that may accumulate flammable fumes or gases. This is an electrical appliance that can briefly spark when electrical connections are made or broken.

Please find the "continuous output" and "surge" power of your inverter below.

MSI300: Continuous output 300W/Surge power 600W
Helpful Formulas:

To convert AMPS to WATTS: AMPS x VOLTS=WATTS
To convert WATTS to AMPS: WATTS÷ VOLTS=AMPS

When you turn on an appliance or a tool that operates using a motor or tubes, it requires an initial surge of power to start up. This surge of power is referred to as the "starting load" or "peak load". Once started, the tool or appliance requires less power to continue to operate. This is referred to as the "continuous load" in terms of power requirements. You will need to determine how much power of your tool or appliance requires to start up and its continued running power requirements.

We recommend that the equipment or appliance switch be in the "OFF" position prior to plugging into the AC receptacle of the inverter.

1. Attach the ring type connector marked with red to the **POSITIVE (+)** DC terminal on the power inverter, and attach the ring connector marked with black to the **NEGATIVE (-)** DC terminal.

2. Tighten the nut on each DC terminal by hand until it is snug. Do not over-tighten.
3. Attach the **NEGATIVE (black)** clip to the **NEGATIVE (-)** battery terminal.
4. Attach the **POSITIVE (red)** clip to the **POSITIVE (+)** battery terminal. Make sure both clips are securely connected to the battery terminals, as a loose connection will cause the voltage to drop and may cause the cables to overheat, resulting in equipment damage or fire.
5. Turn on the inverter.
6. When the power inverter is not in use, disconnect the DC cable clips from the battery to prevent slight discharge from the battery.

OPERATING THE INVERTER

1. When properly connected to a 12V battery, turning on the inverter,LCD screen will light up and indicate the battery voltage and AC outlet(s) are ready.
2. Plug the AC product(s) you wish to operate into the AC outlet(s) and switch them on, one at a time.

CAUTION: If there is more than one AC product connected to the inverter, turn on the higher powered product first.

Through its AC outlet, the inverter is capable of powering most 110V products at its rated power. The inverter will work under input voltage from 11V to 15V DC.

As the battery is used, its voltage will begin to fall. When the inverter senses that the voltage at its DC input has dropped to the range of 10.2V to10.8V DC. Inverter will shut off and LCD reads"Low battery" This protects the battery from being over-discharged.

